

Traverser™

Pacemaker Tunneling Tool

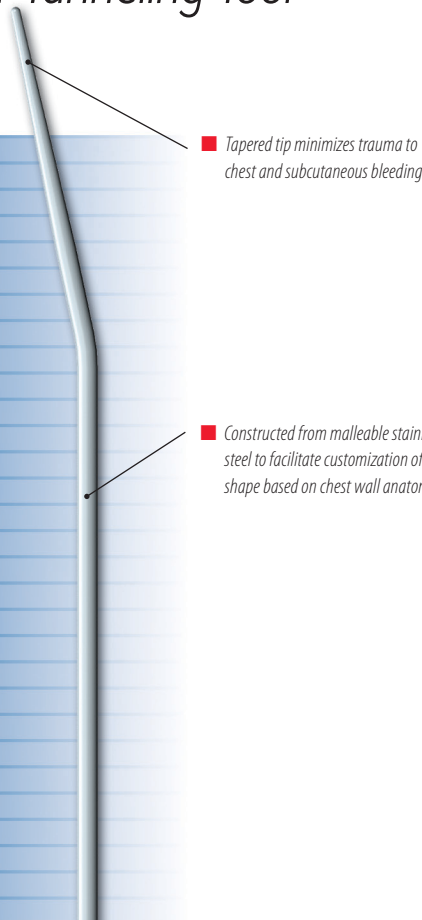

■ Tapered tip minimizes trauma to chest and subcutaneous bleeding

■ Constructed from malleable stainless steel to facilitate customization of shape based on chest wall anatomy

An aid for advancing a pacemaker lead through the subcutaneous tissue of the chest wall to the pacemaker pocket.

In pacemaker implantation, when the problem is getting from 'here' to 'there'— from a pacemaker lead venous insertion site to a remote device pocket—the **Traverser™** from Pressure Products is the answer.

This single-use malleable tool, press fits to the IS-1 connector of any pacemaker lead. Advancing the point of the Traverser from the insertion site, through the subcutaneous tissues of the chest wall to the pacemaker pocket, creates a path through which the lead follows effortlessly. Since the lead and Traverser are of matched diameter, trauma to the chest and subcutaneous bleeding is minimized.

When there 'has to be a better way,' Pressure Products has the answer. The Traverser. Part of a complete line of implantable device therapy products and accessories from Pressure Products.

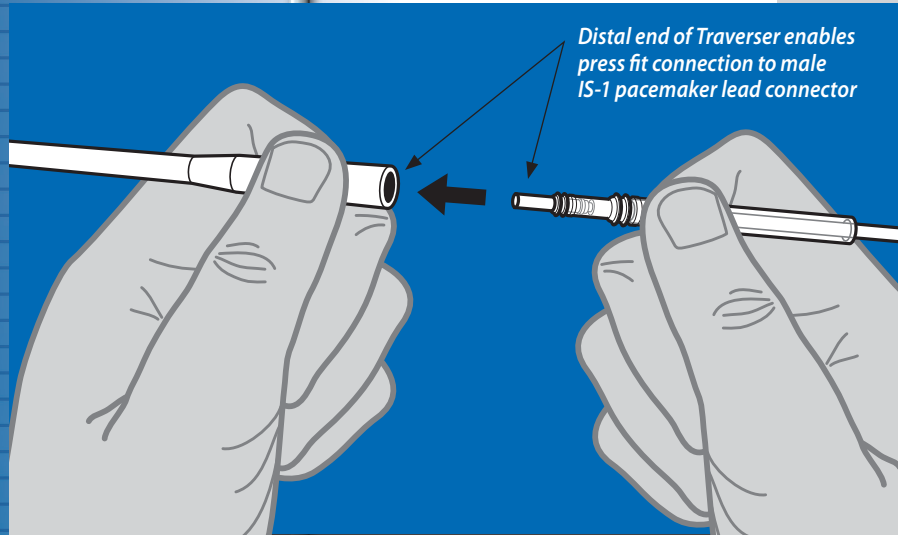

Distal end of Traverser enables press fit connection to male IS-1 pacemaker lead connector

Features:

- Constructed of malleable stainless steel to facilitate shaping the tool to fit the geometry of the chest wall
- Available in three lengths to accommodate different anatomies
- Provides press fit connection to IS-1 pacemaker lead connector
- Unique design minimizes trauma to the chest and subcutaneous bleeding

■ Press fit to male IS-1 pacemaker lead connector

Model	Description	Length
TUN-11	Tunneler for implanting pacemaker lead	11 in
TUN-13	Tunneler for implanting pacemaker lead	13 in
TUN-15	Tunneler for implanting pacemaker lead	15 in